

These patented lift truck tines are extended in length manually by the lift truck driver. The mechanical “movable outer sleeves” are secured to the base fork and cannot be removed. They simply extend and lock into place. These forks offer a lower cost alternative to hydraulic KOOI-forks and they are typically used in applications with less frequent need for tine length change.

FEATURES

- Remain mounted on the forklift truck so they are always available for the driver.
- Lightweight construction that is extended easily to a variety of lengths.
- Cannot catch on objects, like tensioning straps.
- Eliminate safety risks and inconveniences typically associated with loose fork extensions.
- Extension in just one simple movement.
- No hydraulic parts.
- Low maintenance costs.
- No loose parts.



The simplicity of extension forks

Manual extendable forks stay on the forklift truck permanently, saving time, space and money compared to traditional fork extensions (outersleeves). This mechanical option is lower in cost than the hydraulic fork making it ideal for low usage application.

The manner of adjusting the outer sleeve is highly innovative. It simply involves moving a pin (which also serves as a grease nipple) sideways, causing the locker to be retracted. As soon as the locker is disengaged, the outer sleeve can be moved using the other hand until the locker engages again at the different length.

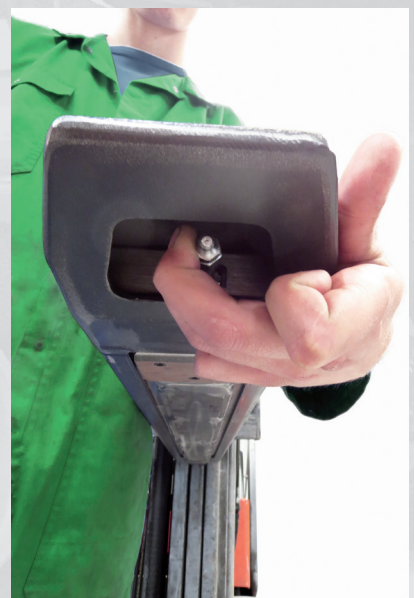

Manual KOOI-REACHFORKS®

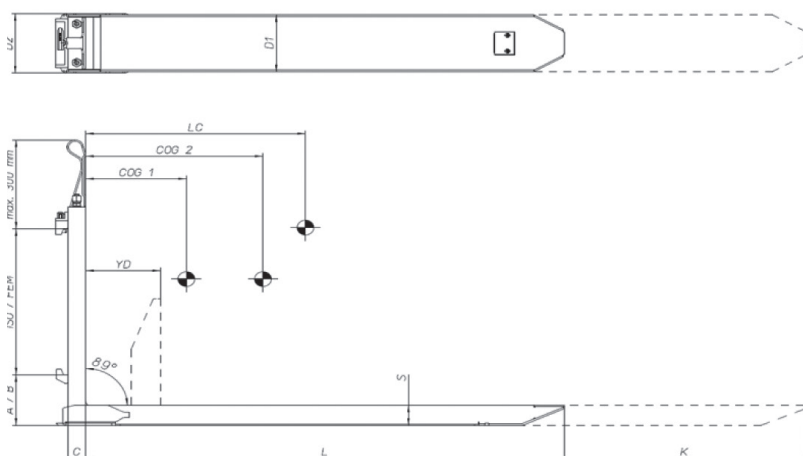

| Model | Capacity on LC 600 mm (kg) | L (mm) | L+K (mm) | C (mm) | Section D1/D2*S (mm) | CoG1 (mm) | CoG2 (mm) | Weight (kg) | ISO/ FEM |
|------------------|-------------------------------|-----------|-------------|-----------|-------------------------|--------------|--------------|----------------|-------------|
| MME 17 0800/0400 | 1700 | 800 | 400 | 40 | 132x41 | 220 | 245 | 95 | 2A |
| MME 17 0800/0200 | | 800 | 200 | | | 220 | 245 | 95 | |
| MME 17 1000/0200 | | 1000 | 200 | | | 295 | 315 | 110 | |
| MME 17 1200/0800 | | 1200 | 800 | | | 380 | 500 | 121 | |
| MME 20 0800/0400 | 2000 | 800 | 400 | 45 | 132x58 | 235 | 295 | 114 | 2A |
| MME 20 0800/0200 | | 800 | 200 | | | 235 | 295 | 114 | |
| MME 20 1000/0200 | | 1000 | 200 | | | 315 | 415 | 131 | |
| MME 20 1200/0800 | | 1200 | 800 | | | 405 | 545 | 150 | |
| MME 20 1400/1000 | | 1400 | 1000 | | | 484 | 640 | 161 | |
| MME 24 0800/0200 | 2400 | 800 | 200 | 45 | 132x45 | 220 | 275 | 104 | 2A |
| MME 24 0800/0400 | | 800 | 400 | | | 220 | 275 | 104 | |
| MME 24 1000/0200 | | 1000 | 200 | | | 300 | 325 | 121 | |
| MME 24 1200/0800 | | 1200 | 800 | | | 385 | 515 | 135 | |
| MME 30 0800/0200 | 3000 | 0800 | 200 | 45 | 132x58 | 220 | 275 | 122 | 3A |
| MME 30 0800/0400 | | 0800 | 400 | | | 220 | 275 | 122 | |
| MME 30 1000/0200 | | 1000 | 200 | | | 300 | 325 | 144 | |
| MME 30 1200/0800 | | 1200 | 800 | | | 390 | 515 | 158 | |
| MME 30 1400/1000 | | 1400 | 1000 | | | 470 | 645 | 176 | |
| MME 35 0800/0200 | 3500 | 800 | 200 | 50 | 132x63 | 230 | 300 | 140 | 3A |
| MME 35 0800/0400 | | 800 | 400 | | | 230 | 300 | 140 | |
| MME 35 1000/0200 | | 1000 | 200 | | | 320 | 390 | 160 | |
| MME 35 1200/0800 | | 1200 | 800 | | | 400 | 550 | 183 | |
| MME 35 1400/1000 | | 1400 | 1000 | | | 485 | 680 | 205 | |

- The lift truck manufacturer must determine the combined extension fork and lift truck capacity.
- Meijer Handling Solutions reserves the right to modify and improve their products without prior notice being given.
- In cold-storage applications KOOI-REACHFORKS® can be used down to -30 degrees Celcius, contact your dealer.